

Utility Protection Dog -Level #1

Level #1:

Obedience- Level#1:

Obedience must be done **off lead**, except for heeling pattern which is allowed to be done using a six (6) foot lead. No prong, choke or electronic collars allowed.

One (1) decoy present on field (stationary- not moving)

Heeling pattern - slow, normal and fast pace in a figure 8 pattern with decoy in center of figure 8. Dog must do two (2) complete figure 8's in each direction. The standard UPD field layout is used with the handler doing the figure "8" around the cones with the decoy in the center.

Two (2) Call throughs -past stationary decoy. The dog will be placed either on a down stay or sit stay at the end of the trial field (25 yard mark) and the handler will proceed to the far end of the trial field (25 yards mark) from the dog. The handler will call the dog to come upon the judge's instructions. The dog will return to the heel position. The handler again will leave their dog on that position and repeat the exercise.

Handler out of sight stay - with dog on down stay for one (1) minute

Approachability -must be able to approach decoy within five (5) feet and engages in conversation and shake hands with decoy. Dog must not show aggression or touch decoy.

Protection phase - Level#1:

All protection work must be done off lead unless otherwise specified. No prong, choke or electronic collars allowed.

1. Decoy wearing bite suit is approx. 75 feet from K-9. Decoy fires (1) shot from .22 cal. blank gun. Handler sends dog to engage decoy. Upon engaging the decoy, the decoy fires two (2) more shots while dog is engaged. Decoy engages dog for approx. 20-30 seconds after the two (2) shots are completed. Upon receiving a signal from the judge, the handler will move from the starting position to within ten (10) feet of where the decoy is currently engaged with the dog, the handler will then "out" the dog. The dog must either stand and guard or return to the heel position. If the dog elects to stand and guard/bark, the handler must be able to command the dog to return to the heel/finish position.
2. Muzzle apprehension - Decoy is fifty (50) feet from handler. Upon a signal from the judge, the decoy will start to run away from the handler. The decoy will run for approximately 30 feet, the judge will then signal the handler to release the dog. The dog

is to engage the decoy for 20-30 seconds. Upon receiving a signal from the judge, the handler will move from the starting position to within ten (10) feet of where the decoy is currently engaged with the dog, the handler will then "out" the dog. The dog must either stand and guard or return to the heel position. If the dog elects to stand and guard/bark, the handler must be able to command the dog to return to the heel/finish position.

3. The decoy is approximately fifty (50) feet from the handler and dog. carrying a padded stick. Upon receiving a signal from the judge the decoy begins to run away from the handler and dog. After running approx. fifteen (15) feet the handler releases the dog to engage the decoy. The decoy will turn. start shouting and yelling and charge at the dog. Upon the dog engaging the decoy, the decoy will strike the dog three (3) times with the padded stick. The dog will not show fear or apprehension and will engage the decoy for approximately 20-30 seconds. Upon receiving a signal from the judge, the handler will move from the starting position to within ten (10) feet of where the decoy is currently engaged with the dog, The handler will then "out" the dog. The dog must either stand and guard or return to the heel position. If the dog elects to stand and guard/bark, the handler must be able to command the dog to return to the heel/finish position.

4. Handler is walking with dog on lead when they will encounter two (2) of the scenarios on the level #1 scenario list. The scenarios will be picked by the judge on the day of testing.

Lost article search: (Simulates handler losing set of keys)

This exercise is done off lead. No prong or electronic collars are allowed.

Handler throws a set of keys into an area 75 ft. X 75 ft. Setup time is twenty (20) minutes. Dog has five (5) minutes to find article. Dog is allowed to either indicate upon keys by laying down/sitting next to keys or pick up keys and bring to handler.

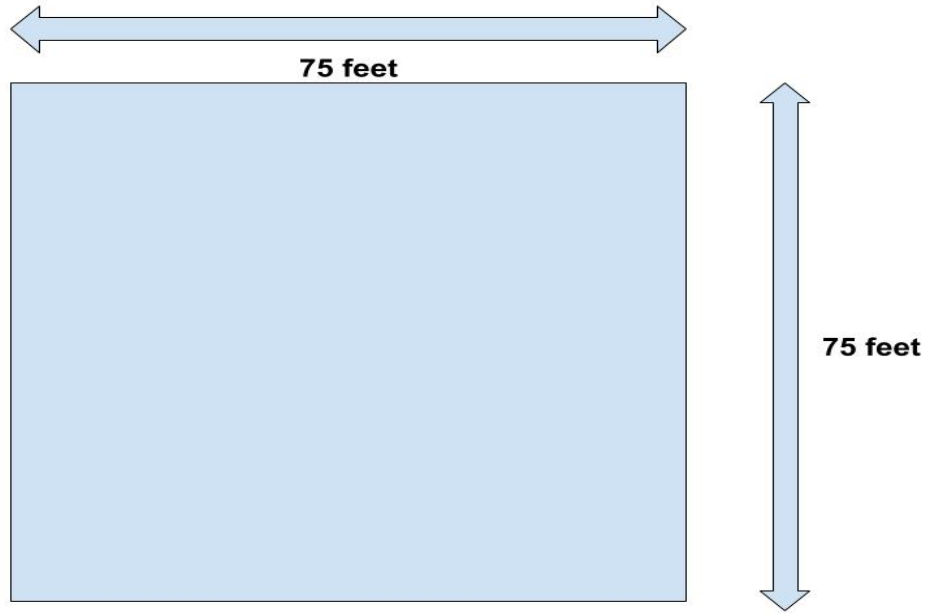

Lost Article Search -Level #1
Handler not allowed to enter the search area.